

Allergy and Anaphylaxis Action Plan and Medication Orders

Student's Name: _____ D.O.B. _____ Grade: _____

School: _____ Teacher: _____

Place child's
photo here

ALLERGY TO: _____

History: _____

Asthma: YES (Higher risk for severe reaction) NO

◇ STEP 1: TREATMENT ◇

SEVERE SYMPTOMS:

One or more of the following:

LUNG: Short of breath, wheeze, repetitive cough
HEART: Pale, blue, faint, weak pulse, dizzy, confused
THROAT: Tight, hoarse, trouble breathing/swallowing
MOUTH: Obstructive swelling (tongue and/or lips)
SKIN: Many hives over body

Or **combination** of symptoms from different body areas:

SKIN: Hives, itchy rashes, swelling (e.g., eyes, lips)
GUT: Vomiting, crampy pain



1. INJECT EPINEPHRINE IMMEDIATELY

2. Call 911
3. Begin monitoring (see box below)
4. Give additional medications:*
 - Antihistamine
 - Inhaler (quick relief) if asthma

*Antihistamine & quick relief inhalers are not to be depended upon to treat a severe reaction (anaphylaxis). USE EPINEPHRINE

Give epinephrine immediately if the allergen was definitely ingested, even if there are no symptoms

MILD SYMPTOMS ONLY:

MOUTH: Itchy mouth
SKIN: A few hives around mouth/face, mild itch
GUT: Mild nausea/discomfort



1. GIVE ANTIHISTAMINE

2. Stay with student; alert healthcare professionals and parent
3. If symptoms progress (see above), USE EPINEPHRINE
4. Begin monitoring

DOSAGE

Epinephrine: inject intramuscularly using auto-injector (check one): 0.3 mg 0.15 mg

Administer 2nd dose if symptoms do not improve in _____ minutes

Antihistamine: (brand and dose) _____

If Asthmatic: (brand and dose) _____

Student has been instructed and is capable of carrying and self-administering own medication. Yes No

Provider (print) _____ Phone Number: _____

Provider's Signature: _____ Date: _____

If this condition warrants meal accommodations from food service, please complete the medical statement for dietary disability

◇ STEP 2: EMERGENCY CALLS ◇

1. If epinephrine given, **call 911**. State that an allergic reaction has been treated and additional epinephrine, oxygen, or other medications may be needed.

2. Parent: _____ Phone Number: _____

3. Emergency contacts: Name/Relationship Phone Number(s)

a. _____ 1) _____ 2) _____

b. _____ 1) _____ 2) _____

EVEN IF PARENT/GUARDIAN CANNOT BE REACHED; DO NOT HESITATE TO ADMINISTER EMERGENCY MEDICATIONS

I give permission for school personnel to share this information, follow this plan, administer medication and care for my child and, if necessary, contact our health care provider. I assume full responsibility for providing the school with prescribed medication and delivery/monitoring devices. I approve this Severe Allergy Care Plan for my child.

Parent/Guardian's Signature: _____ Date: _____

School Nurse: _____ Date: _____

To be completed by healthcare provider

Student Name: _____ DOB: _____

TRAINED/DELEGATED STAFF MEMBERS

- 1. _____
- 2. _____
- 3. _____
- 4. _____
- 5. _____

- Room _____
- Room _____
- Room _____
- Room _____
- Room _____

Self-carry contract on file. Yes No

Medication located in: _____

EPIPEN® (EPINEPHRINE) AUTO-INJECTOR DIRECTIONS

- 1. Remove the EpiPen Auto-Injector from the plastic carrying case.
- 2. Pull off the blue safety release cap.
- 3. Swing and firmly push orange tip against outer thigh.
- 4. Hold for approximately 10 seconds.
- 5. Remove and massage the area for 10 seconds.

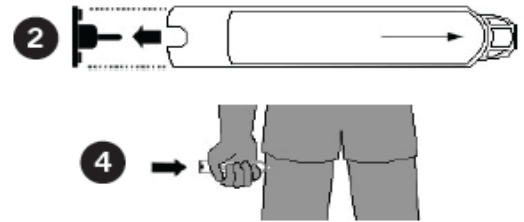

AUVI-Q™ (EPINEPHRINE INJECTION, USP) DIRECTIONS

- 1. Remove the outer case of Auvi-Q. This will automatically activate the voice instructions.
- 2. Pull off red safety guard.
- 3. Place black end against outer thigh.
- 4. Press firmly and hold for 5 seconds.
- 5. Remove from thigh.

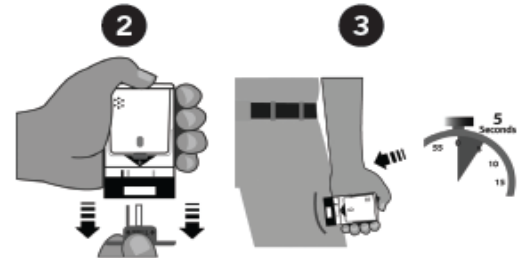

ADRENACLICK™/ADRENACLICK™ GENERIC DIRECTIONS

- 1. Remove the outer case.
- 2. Remove grey caps labeled "1" and "2".
- 3. Place red rounded tip against outer thigh.
- 4. Press down hard until needle penetrates.
- 5. Hold for 10 seconds. Remove from thigh.



**Once epinephrine is used, call 911.
Student should remain lying down or in a comfortable position.**

Additional information: